

# ARRI®

## Instruction

01 / 2021

# Orbiter®



## Case for Orbiter

## Safety instructions

- Please read these instructions carefully before using the product for the first time. The following text contains important information for safe handling.
- For your personal safety, please observe the notes and safety instructions.
- Observe all common and local safety regulations.
- Please keep these instructions for possible subsequent owners.
- The handles are not intended for lifting to great heights (e.g. crane). The handles may break off.
- Always mount the protective cap and disconnect all cables for transport.

## Maintenance

Inspect the product regularly for visible damage.

- Do not use a deformed product.
- Do not use a product with a defective component.  
Repair the defective component immediately.

## Intended use

This product is an accessory for the „Orbiter“ luminaire and its accessories. The Orbiter is intended to illuminate persons and objects. The case is intended to carry and store one ARRI Orbiter including accessories as described.

Always follow the safety information.

Any usage other than described above is not permitted and can damage the product and lead to associated risks such as short-circuit, fire, electric shock, etc.

This product fulfills all legal requirements.

ARRI is not liable for damages caused by improper use or incorrect operation.

## Position of contents

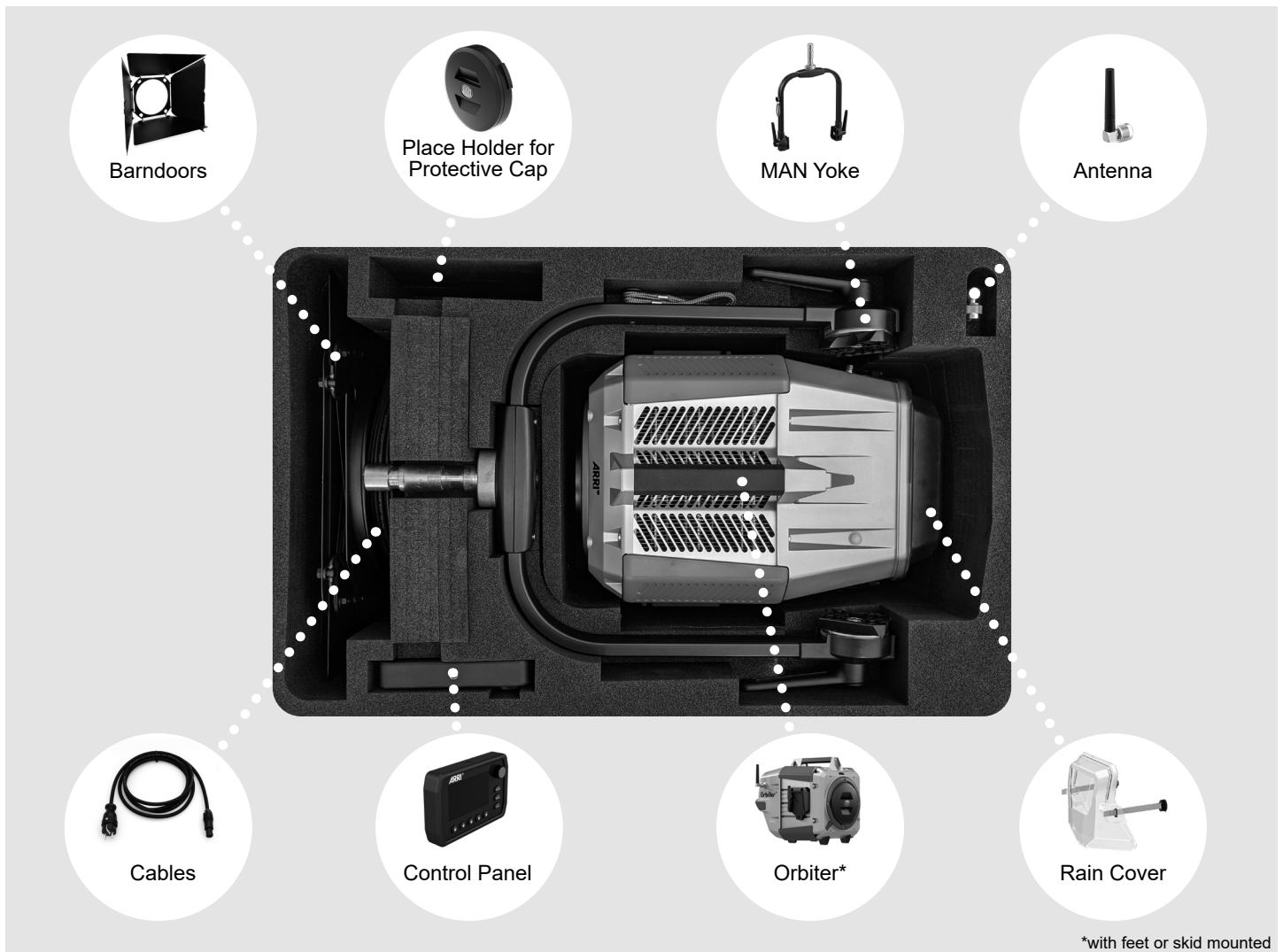

## Specification

ARRI Ident. No.	L2.0034626
Dimensions (LxWxH)	816 x 540 x 426 mm / 32.1 x 21.3 x 16.8"
Weight	15 kg / 33.1 lbs. net (without Orbiter & accessories) max. 34 kg / 75 lbs. gross (incl. Orbiter & accessories)

## Compartment and inlays

The compartments of the case are designed with three removable inlays to store the different configurations of the Orbiter. Always remove Orbiter and accessories before pulling out the foam inlays. Otherwise the foam inlays can tear.

The following foam inlays are flexible and can be removed:

### 1. Inlay for cables and barndoors

It must always remain in the case as it protects the cables and barndoors while transporting.

### 2. Inlay for Orbiter without skid

It holds the Orbiter in place when the skid is not mounted.

### 3. Inlay for Orbiter without rain cover

It holds the Orbiter in place when the rain cover is not mounted.

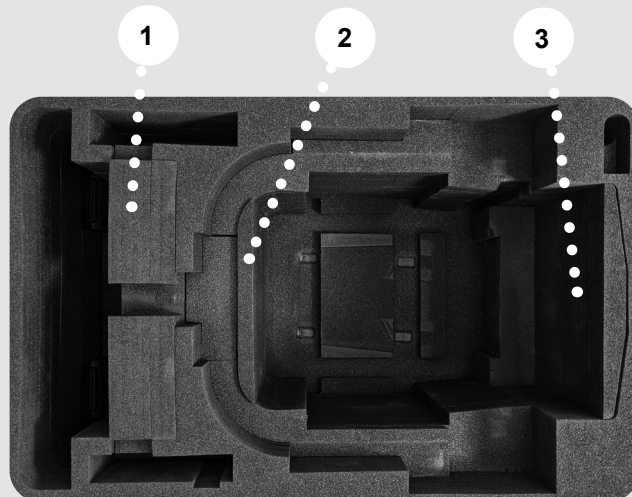

## To pack Orbiter with and without skid

### Orbiter with skid mounted:

Remove inlay no. 2

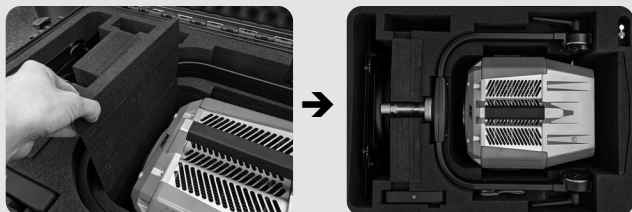

### Orbiter with feet mounted:

Keep inlay no. 2

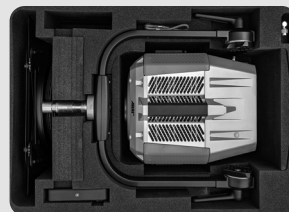

## To pack Orbiter with and without rain cover

### Orbiter with raincover mounted:

Remove inlay no. 3

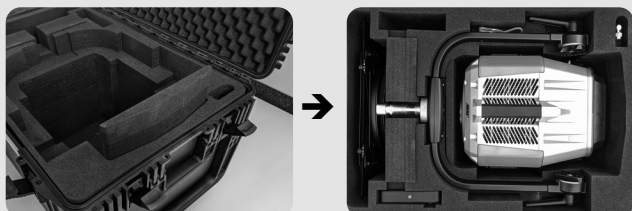

### Orbiter without raincover:

Keep inlay no. 3

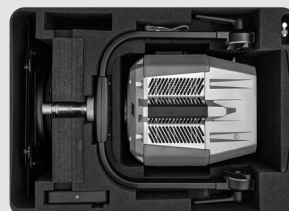

## To pack barndoors and cables

Barndoor 245 mm

Cables

Barndoor 168 mm



## ARRI Service

In case of technical problems please visit us at

[www.arri.com](http://www.arri.com)

Arnold & Richter Cine Technik GmbH & Co. Betriebs KG  
Global Application & Services  
Arriweg 17  
D-83071 Stephanskirchen  
Germany

Design and specification are subject to change without notice.

**ARRI** 